

Coaxial Cables

RG-59/U

RoHS REACH CE

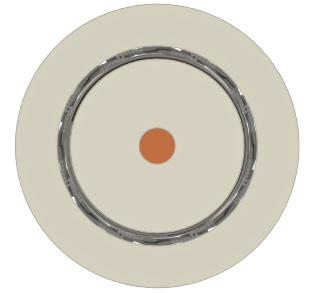
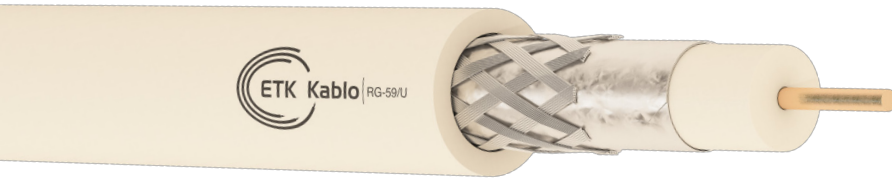

Application

· Distribution cable for indoor CATV-CCTV systems as connection cable for satellite systems where low attenuation is required.

Cable Construction

- 1 - Conductor : 0.83 mm \varnothing electrolytic solid copper conductor
- 2 - Insulation : 3.90 mm \varnothing physical foam polyethylene
- 3 - Screen : Al/PET tape
- 4 - 2nd Screen : Tinned copper braiding
- 5 - Outer Jacket: UV resistant PVC, halogen-free, polyethylene outer jacket

Technical Characteristics

Insulation Resistance	Mutual Capacitance	Propagation Velocity	Operating Voltage	Test Voltage	Characteristic Impedance
>2000 M Ω xkm	75 pF/m \pm 3 pF/m	84%	1.1 kV	2.5 kV	75 Ω \pm 3 Ω

Mechanical Characteristics

Bending Radius	Temperature Range Operating
10xD mm	-40 $^{\circ}$ C~+70 $^{\circ}$ C

Standards

Smoke Density Test ¹	Corrosive Gas Test ¹	Halogen-free Test ¹	Flame Retardancy Test ²
IEC 61034-2, VDE 0482-1034-2, EN 61034-2	IEC 60754-2, VDE 0482-267-2-3, EN 50267-2-3	IEC 60754-1, VDE 0482-267-2-1, EN 50267-2-1	IEC 60332-1-2, VDE 0482-332-1-2, EN 60332-1-2

Attenuations

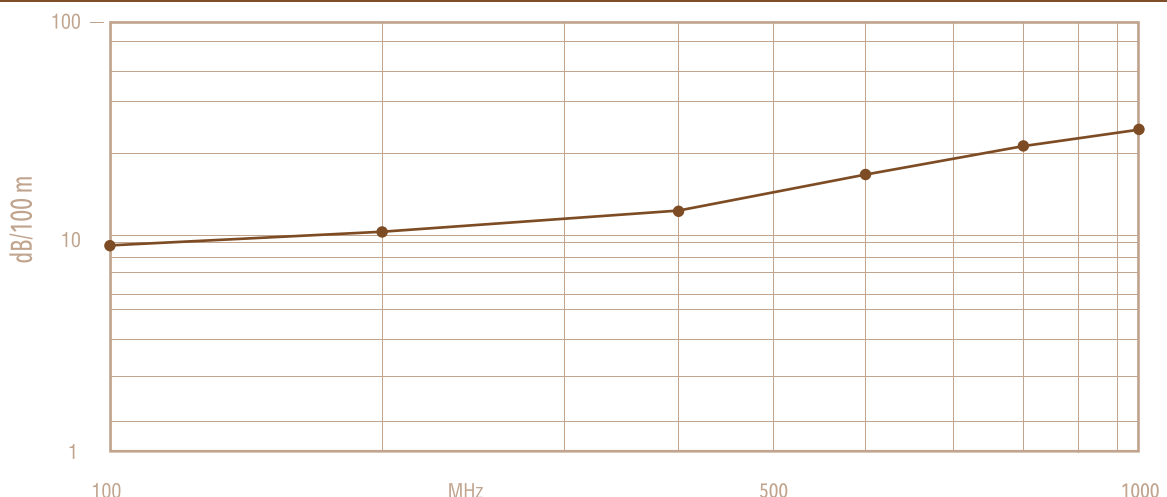

Notes

¹ Only applies to halogen-free jacketed cables.

² Only applies to PVC and halogen-free jacketed cables.

RG-59/U

Part Number	Conductor Count	Conductor Diameter (mm)	Approx. Cable Diameter (mm)	Copper Weight (kg/km)	Approx. Weight (kg/km)	Packing Lengths (m)
3.705.1.5.2.0083.1.5900	1	0.83	6.4	26	56	100/500/1000