

Outdoor Telephone Cables

Drop Wire Aerial

Drop Wire Aerial



Application

· Designed to provide service extension to the subscribers.

Cable Construction

- 1 - Conductor : Electrolytic annealed tinned copper (TS 3544, IEC28, ASTM B3).
- 2 - M. Wire : Galvanized steel messenger wire (ASTM A 475-66T).
- 3 - Outer Jacket: Linear low-density or medium-density, UV resistant black polyethylene outer jacket (ASTM D 1248).

Technical Characteristics

	Conductor Diameter	
	0.80 mm	1.00 mm
Conductor Resistance Ω/km (20 °C)		
Maximum Average	28,96	23,39
Insulation Resistance MΩ/km (500 V DC)	>15000	>15000
Dielectric Strength		
V (DC, 1 minute)		
Pair - Pair	5600	5600
Pair - Screen	5600	5600

Drop Wire Aerial

Dimensions	a	b	d	D	r	s	g	l	m	n	o
Nominal Values	0.8 mm	1.2 mm	2.8 mm	3.2 mm	0.3 mm	0.5 mm	3.3 mm	9.4 mm	0.7 mm	0.6 mm	0.3 mm
	1.0 mm	1.4 mm	3.0 mm	3.4 mm	0.3 mm	0.5 mm	3.5 mm	10 mm	0.7 mm	0.6 mm	0.3 mm
Tolerance	0.012 mm	0.1 mm	0.1 mm	0.1 mm	0.1 mm	0.2 mm	0.2 mm	0.5 mm	0.1 mm	0.1 mm	0.1 mm

Notes

Reference Standard: TS EN 60708

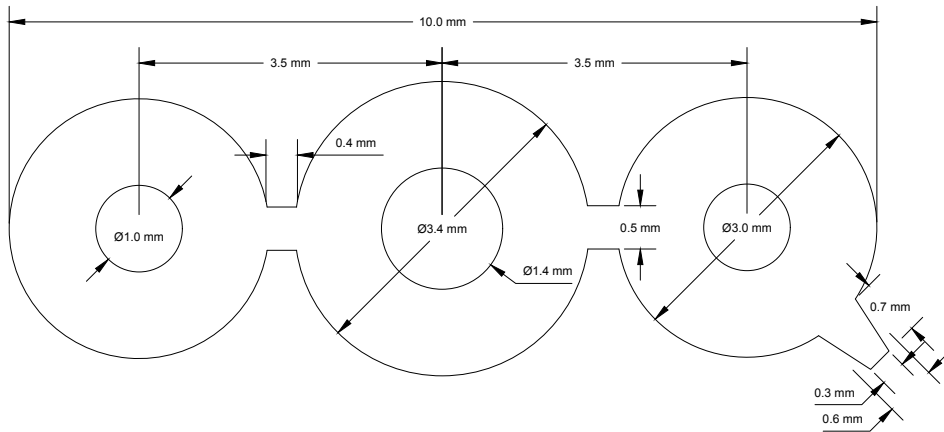
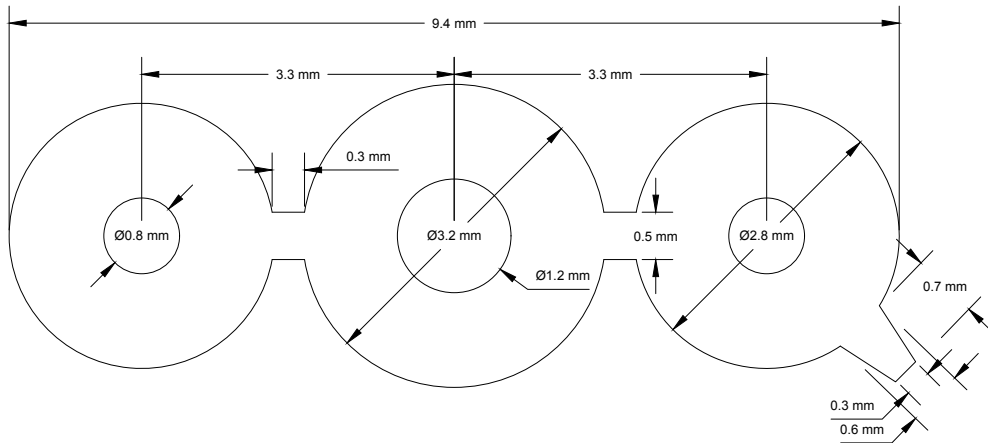

Drop Wire Aerial

Part Number	Conductor Count	Conductor Diameter (mm)	Approx. Cable Diameter (mm)	Copper Weight (kg/km)	Approx. Weight (kg/km)	Packing Lengths (m)
3.182.0.0.1.0080.0.0002	2	0.8	2.9	9.8	36	1000/2000
3.182.0.0.1.0100.0.0002	2	1	3.1	15.2	43	1000/2000

Drop Wire Aerial (Tinned Copper)

Part Number	Conductor Count	Conductor Diameter (mm)	Approx. Cable Diameter (mm)	Copper Weight (kg/km)	Approx. Weight (kg/km)	Packing Lengths (m)
3.183.0.0.1.0080.0.0002	2	0.8	2.9	9.8	36	1000/2000
3.183.0.0.1.0100.0.0002	2	1	3.1	15.2	43	1000/2000